

**FASI RISOLUZIONE INTERFERENZA 22**

**VIA MORANDI**







Via Cellini

Via Cristei

CAVITÀ PER TETTO





Via Mario Schifano

Via Cellini

Via Cellini

Chiesa P  
45.49°N



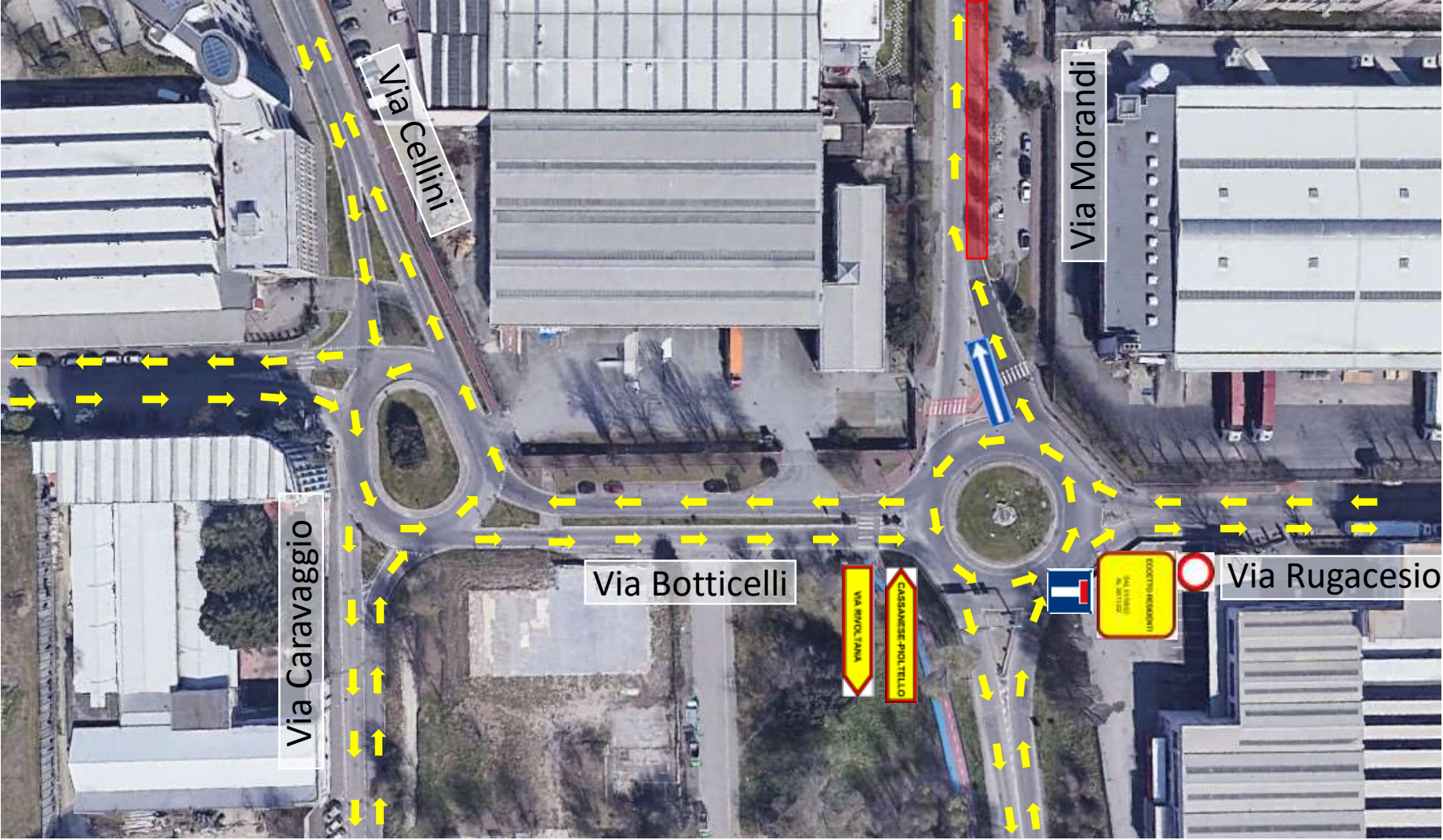

# Dettaglio Cartellonistica di Cantiere

ORDINE

X 1



X 1

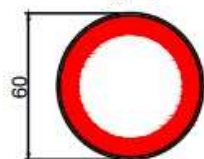

X 3

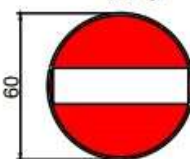

X 1

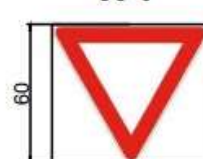

X 2



X 3



X 1



X 2

X 1



X 1

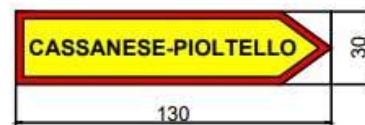

X 1



X 1



X 2

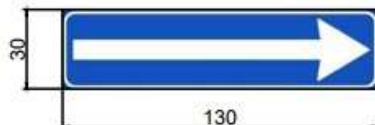

X 1

